

mFi™ QUICK START GUIDE

Door Sensor

Model: mFi-DS



Introduction

Thank you for purchasing the Ubiquiti mFi™ Door Sensor. The mFi-DS is designed for use with the mFi mPort. Once they are connected, you can use the mFi Controller software to monitor your sensors using your Web browser.

Hardware Overview

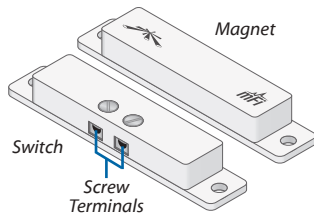

Switch Features *Screw Terminals* and attaches to the frame of the door or window.

Magnet Attaches to the door or movable part of the window.

Installation Requirements

- mFi mPort
- 2.4 mm Flathead Screwdriver
- Phillips Screwdriver (Optional)

Installation Tips

- For optimal performance, use one of these end-to-end configurations:

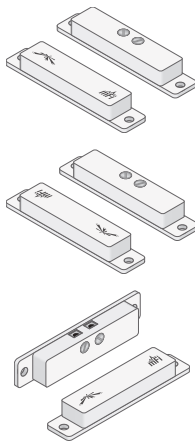

- Do NOT use an offset or T-shaped configuration:

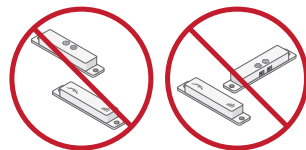

- The maximum gap is 20 mm.

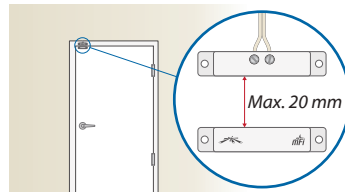

- On a door, we recommend that you install the mFi-DS as high up as possible, either at the top or on the side opposite of the hinges.

Ubiquiti Networks Support

Email: support@ubnt.com

Phone: **408-942-1153**
(9 a.m. - 5 p.m. PST)

Online Resources

Wiki Page: wiki.ubnt.com

Support Forum: forum.ubnt.com

Downloads: downloads.ubnt.com



www.ubnt.com

© 2012 Ubiquiti Networks, Inc. All rights reserved.

JL070212

Wiring Instructions

Perform these steps to connect the wire from the *Switch* to the mPort:

1. Insert each pre-stripped wire at one end of the 22 AWG Double Wire into each *Screw Terminal*.

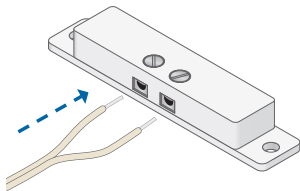

2. Tighten each *Terminal Screw*.



3. On the other end of the 22 AWG Double Wire, repeat steps 1-2 to connect the wire to the *I* and *O* Terminals of the *Terminal Block* that is included with the mPort.

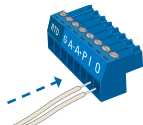

4. Connect the *Terminal Block* to the *Terminal Block Port* (labeled Port 3 on the mPort).

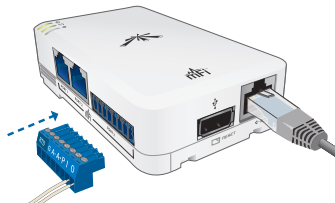

Mounting Instructions

You have two mounting options available:

- Use the self-adhesive.
- Use a Phillips screwdriver and the 3 x 12 mm *Mounting Screws*.

1. Mount the *Magnet* onto the door or movable part of the window.

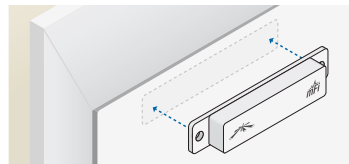

2. Align the *Switch* with the *Magnet* so their edges line up when the door or window is closed.

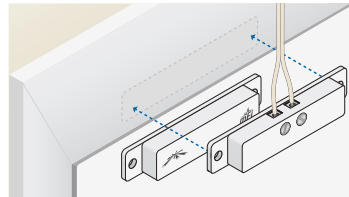

3. Mount the *Switch* onto the frame of the door or window.

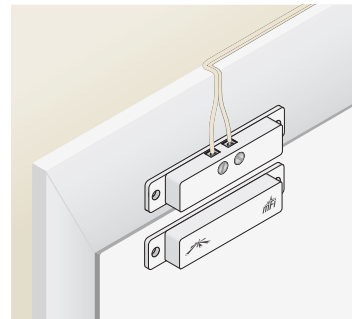

Refer to the User Guide on the CD-ROM that was included with your mFi mPort for instructions on configuring the mFi-DS in the mFi Controller software. The User Guide is also available at

www.ubnt.com/mfi