

ARTEMIS

THERMAL FRONT ATTACHMENT

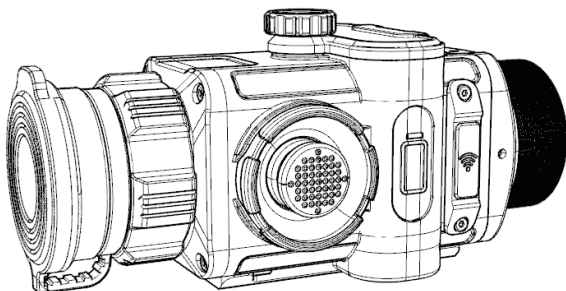

Attention!

Export of **Artemis 25/35** models
May have export limitations depending on
the laws in your region.



Attention!



The proper usage of the device is important for safe exploitation!
Therefore read carefully the present manual!



If the device was left in storage for a longer period of time, before exploitation check its functionality.



Disassembling of the device is prohibited, except in authorized repair centers.



The external optical surfaces should be clean at all times. Touching the optical surfaces with bare hands is not recommended.



Sand and sea water can damage the optical coatings!



Do not point the device directly at the sun!



Image performance is dependent on scenery and atmosphere conditions. Contrast in the same image may vary as a function of the time of day due to the effect of the sun. For example, at sunset objects will have absorbed different levels of heat resulting in greater temperature differences and better contrast.



When left in storage for a longer period of time, batteries have to be removed and stored in polyethylene bags to prevent contact with metal. (It is recommended to recharge the batteries every two to three months)



When carrying or transporting the device, put the protective lens cap!



Condensation can cause fogging of the optical surfaces! Condensation occurs when the temperature or humidity changes as follows:

- When moving the device from cold to warm place or vice versa;
- In places with high humidity.

When equalizing the temperature of the device with the environmental, the condensation disappears. Use the towel to remove moisture.



Clean the lens surfaces with the Lens Cloth or with the napkin!



LEGAL NOTICE

Before attaching to weapons, check the regional legal regulations in the area of application.

The attachment to a weapon is always the sole responsibility of the user.

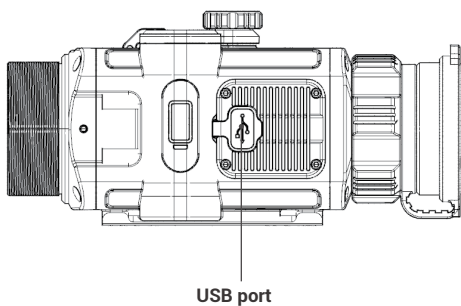
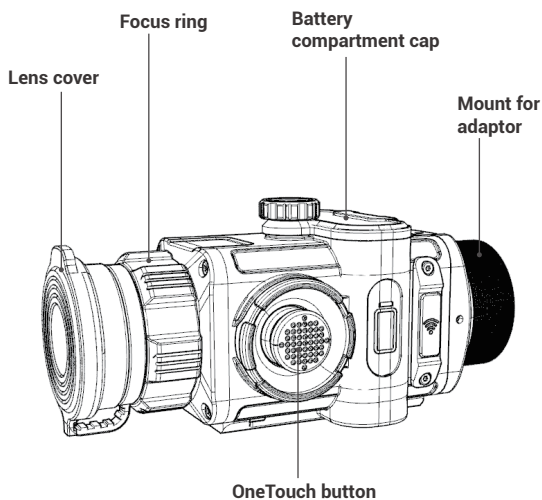

NOTE

All images used in this instruction manual are for illustrative purpose only. Actual product may vary due to product enhancement.

**ATTENTION!**

The main operations are performed through the "OneTouch Button" (5 position button) .

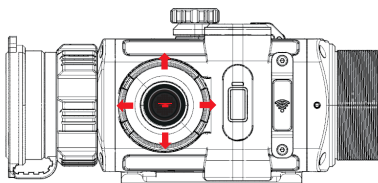
**ATTENTION!**

Turn off the device after usage, otherwise you can permanently damage the batteries!

Middle



Up



Down



Left



Right



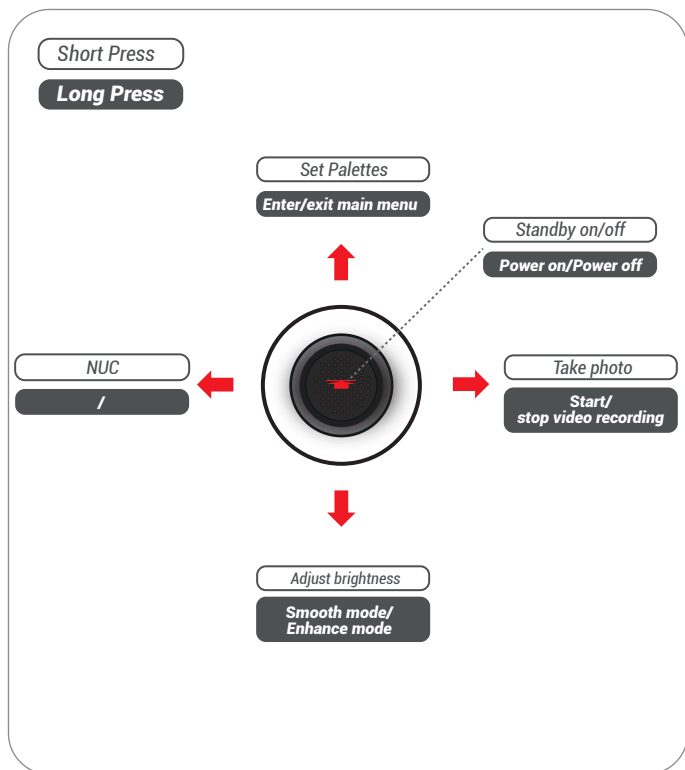

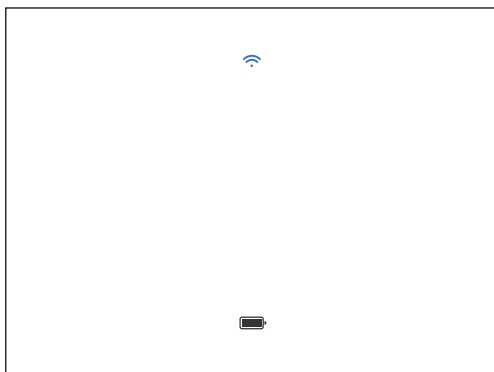

The status icons are respectively located at the top and bottom of the display and show information on the actual operating status of the device, including:

- Battery capacity
- Wifi status

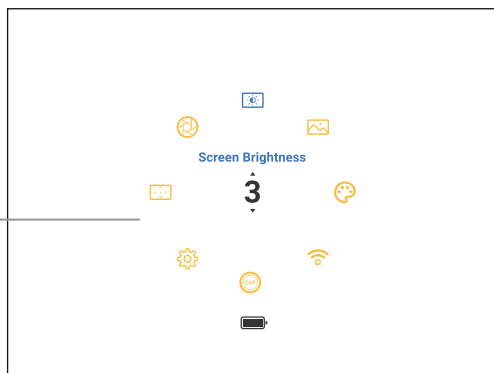

Main menu setting icons

The Quick menu allows change of basic settings.

Up



Palette

Short press **Up** button to switch palette.

WH---WhiteHot

WW---WarmHot

BH---BlackHot

CG---ColdGreen

GB---Glowbow

RB---Rainbow

Main Menu

Long Press **Up** Button to enter/exit Main menu.

Down



Screen Brightness

Short press **Down** button to switch brightness from 1 to 5.

Image Mode

Long press **Down** button to switch between Smooth mode and Enhance mode.

Left



NUC

Short press **Left** button to do Manual Non-uniformity calibration.

Right



Take Photo

Short press **Right** button to take a photo.

Start/Stop Video Recording

Long press **Right** button to start/stop video recording.

Middle



Standby Mode

Short press **Middle** button to enter/exit Standby mode.

Long press **Middle** button to Power on/off the device.

Start up image

Long press **Middle** button to power on the device.



Power off image

Long press **Middle** button to power off the device after counting down 3-2-1.

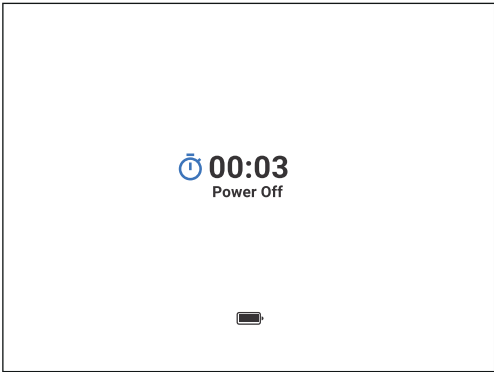

Take Photo/Video on-boarding

Short Press **Right** button to take a photo, number of photos will shown on bottom screen.

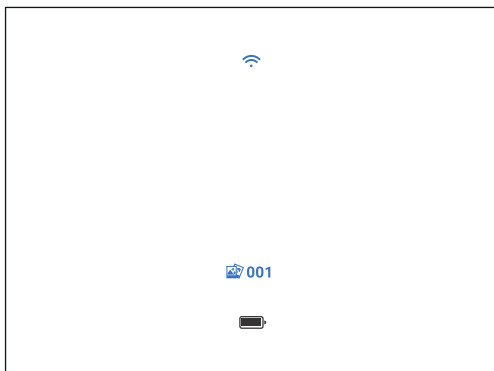

Long Press **Right** button to start/stop video recording, recording icon will be shown on screen.

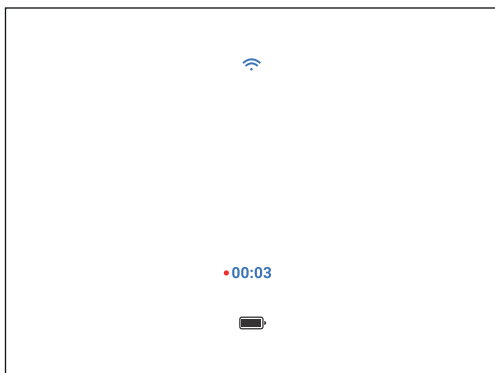

Please note the following before using :

You can not take photos/videos while connecting with PC. Otherwise the photos/videos are not actually saved.

When you take photos, do not press too quickly, always wait until 001 disappears before you take 002.

Take Photo/Video by CONOTECH

User can take photo / video on board or by CONOTECH App.
Replay on Smart phone.

To get started, install the free CONOTECH App on your mobile device.
You can search and download at App Store and GooglePlay.

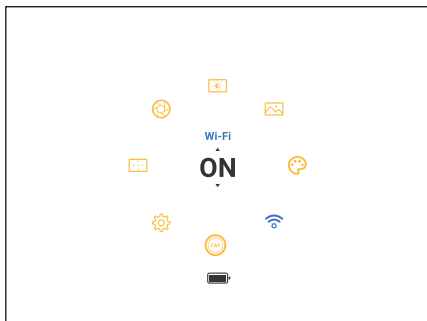

CONOTECH



Find WIFI named:
Artemis *****



Enter password:
12345678



After wait for 10s



How to replay on PC?

Connect the Type-C usb cable to PC.

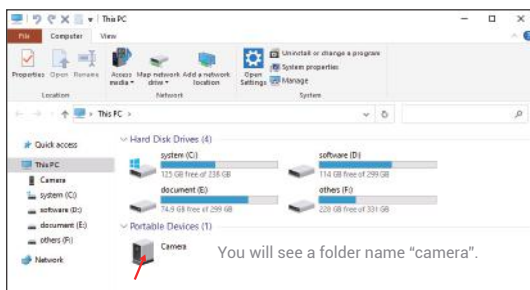

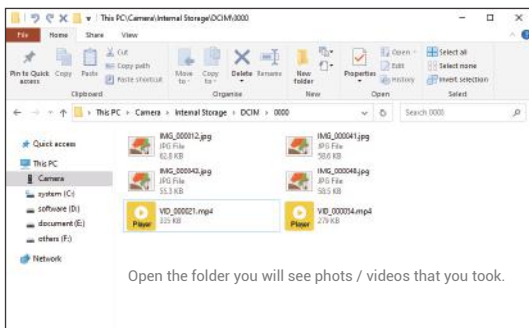
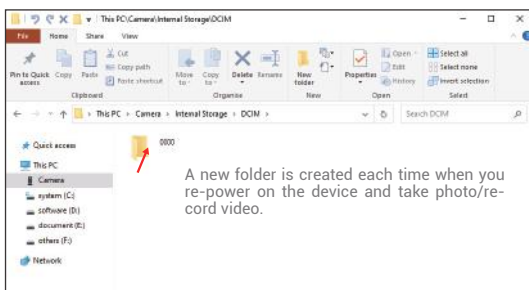
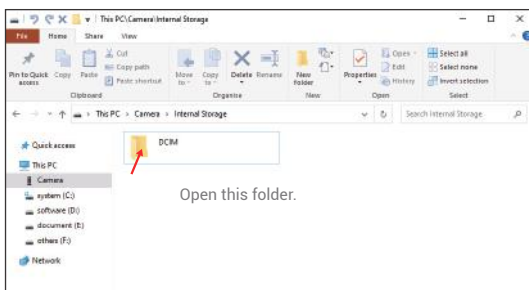

Long press Up button to enter main menu.



Short press Right button to move the cursor from 1 to 8, short press Left button to move the cursor from 8 to 1.

- 1) Screen Brightness
- 2) Image Mode
- 3) Palette
- 4) WiFi
- 5) Silent Calibration
- 6) Advance Setting
- 7) Alignment
- 8) Auto NUC



Screen Brightness

Short press **Up/Down** button to change Screen Brightness from 1~5.
When the brightness is adjusted to 5 or 1, change the setting according to the narrow points.



Image Mode

Short press **Up/Down** button to switch between Smooth mode and Enhance mode.





Palette

Short press **Up/Down** button to switch the Palette from WH-WW-BH-CG-GB-RB.



WiFi

Short press **Up/Down** button to turn on/off WiFi, the default status is WiFi off.
With  shown in display means WiFi is on, without  shown in display means WiFi is Off.



Slitent Calibration

Short press Up/Down button to do slitent calibration, close the lens cover, complete after counting down 3-2-1



Advance Setting

Short press **Up/Down** button to enter submenu of Advance Setting.
Long press **Up** button to exit submenu of Advance Setting.

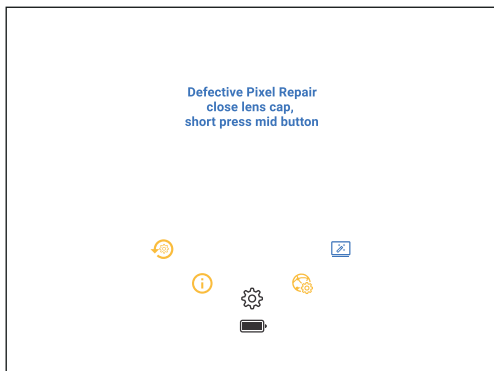



Defective Pixel Repair

Short press **Left/Right** button to move the cursor to Defective Pixel Repair, close lens cap and short press **Middle** button to start Defective Pixel Repair, complete after counting down 3-2-1.



Language

Short press **Left/Right** button to move the cursor to Language, short press **Up/Down** button to select Language, the default Language is English.

EN---English DE---German RU---Russian
CZ---Czech ES---Spanish



Device Info

Short press **Left/Right** button to move the cursor to show Device Info.



Restore Factory Settings

Short press **left/Right** button to move the cursor to Restore Factory Settings.

Short press **Up/Down** to select Yes/No. Short press **Middle** button to set menu settings to default when selecting Yes.

The following settings will be restored to original values before changes made by user:

WiFi Status
Palette
Screen Brightness
Image Mode
Language
Calibration Mode



Alignment

Artemis is adjusted with accuracy from 0.1 mrad to 0.3 mrad before shipping out. The final accuracy depends on user's rifle scope, parallax and shooting distance. So Artemis offers super accuracy by alignment.

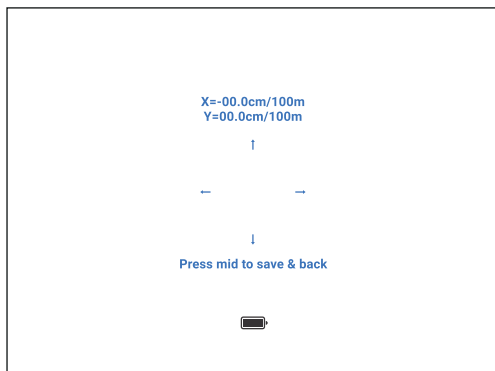

Operating Instructions for accuracy correction:

- 1) Aiming your daytime scope to the middle of target and shoot which is to test and control good daytime scope accuracy.
- 2) Clip Artemis onto the daytime scope by adapter. Aim to the thermal target and shoot again.
- 3) Measure horizontal distance x and vertical distance y between shooting position and target from step 2.
- 4) Short press **Up/Down** button to enter Alignment.
- 5) Short/long press **Up/Down** button to adjust the value of y , short/long press Left/Right to adjust the value of x .
 - Short press **Left** button, $x = -2.4\text{cm}$ on 100m
 - Long press **Left** button $x = -24\text{cm}$ on 100m
 - Short press **Right** button $x = 2.4\text{cm}$ on 100m
 - Long press **Right** button $x = 24\text{cm}$ on 100m
 - Short press **Up** button $y = 2.4\text{cm}$ on 100m
 - Long press **Up** button $y = 24\text{cm}$ on 100m
 - Short press **Down** button $y = -2.4\text{cm}$ on 100m
 - Long press **Down** button $y = -24\text{cm}$ on 100m
- 6) Short press **Middle** button to save and back.

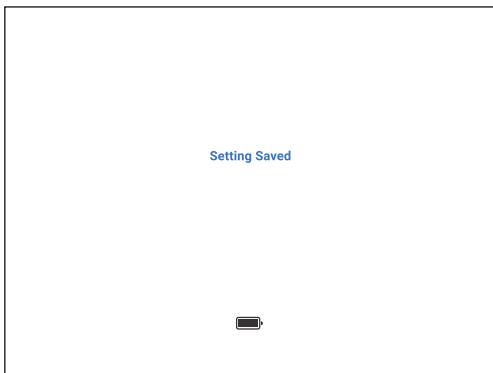

Auto NUC

Short press **Right/Left** button to move the cursor to Auto NUC.
Short press **Up/Down** button to switch ON/OFF.

Note: Short press **Left** button in real-time image to do Non-uniformity calibration.

Battery Installation

1. When the icon  is appeared on the display, please replace the new battery to supply;
2. It is necessary to power off before replacing the batteries, turn the battery compartment knob counterclockwise until stop.
3. Please install two 18500 batteries according to the positive and negative signs. Otherwise, the Artemis will not start.
4. Close the battery compartment knob.

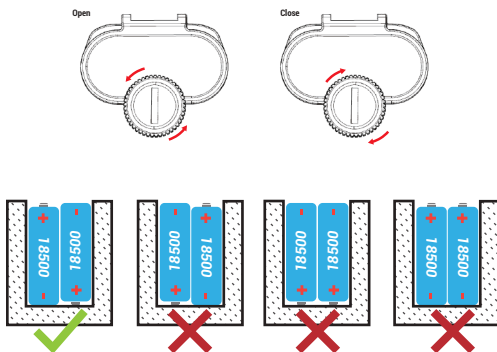

Battery charge level is displayed on the status bar.



1. Power supply / Firmware update



The charging port is for 5V Type-C USB, serves for external power supply, data transmission and firmware update.

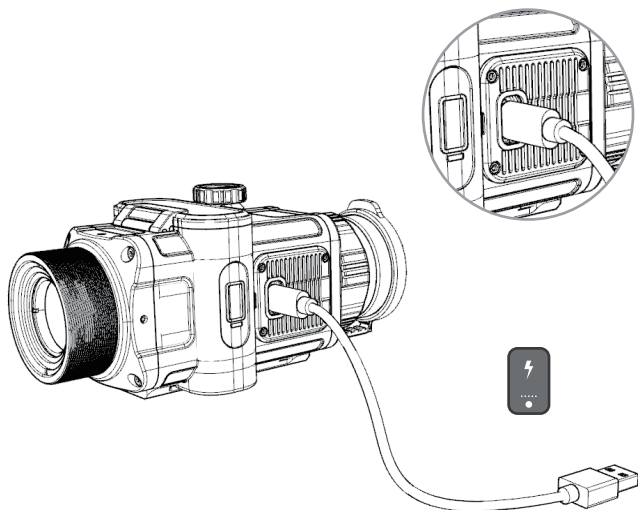

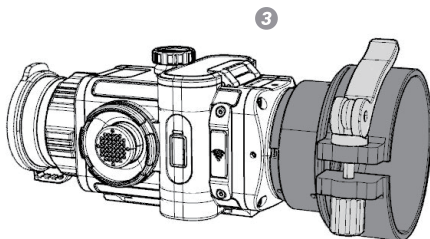
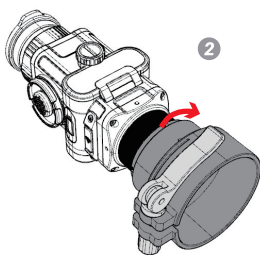
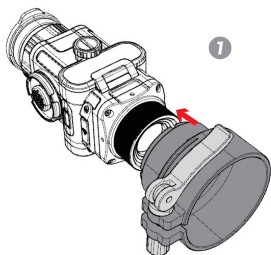

- Before storing it, clean obligatory the device (if on its surface there are moisture, dust or traces of dirt)!
- Make sure that there are no traces of moisture, and the battery compartment is empty!
- It is also possible for a short periods of time device to be stored in a suitable soft pack, bag or cartridge box.
- The premises in which the device is kept for long term have to be dry, enclosed, unheated and ventilated.
- During the storage should not be allowed exposure to aggressive environments, temperatures below -50°C and above $+60^{\circ}\text{C}$, relative humidity greater than 80%, and prolonged periods of direct sunlight.
- Before each transportation, the product should be neatly packed in its original packaging (transport bag) and all other items and accessories should be carefully and steadily placed in the bag. After that the bag should be steadily placed in the transport suitcase.
- You can ship the product with all types of transport at different distances and at altitude up to 12000 m.

Technical Data Sheet		
	Artemis 25	Artemis 35
Detector		
Type	Uncooled Vox	
Resolution	384x288	
Frame rate	50Hz	
Pitch	12μm	
Spectral range	8-14μm	
NETD	<25mk	
Optical Characteristics		
Objective lens	25mm/F1.0	35mm/F1.1
Magnification	1X	1X
FOV	10.6°x7.9°	7.5°X 5.6°
FOV at 100m	18.4mX14m	13.2mX10m
Close-up range	3m	
Functions		
Palette	BlackHot, WhiteHot, RedHot, Glowbow, ColdGreen, Rainbow	
Start up time	Less than 3 seconds	
Detail enhancement	Yes	
WIFI	Yes	
Storage capacity	32G	
Standby mode	Yes	
Display		
Type	OLED	
Resolution	1024×768	
Power Supply		
Battery	2×18500	
External power supply	5V Type-C	
Working time with battery	6.5h	
Physical Characteristics		
Weight without battery	450g	470g
Size	145*67*69mm	155*67*69mm
Environmental Compatibility		
Water proof	IP67	
Operating temperature	-20℃ -50℃	
Storage temperature	-40℃ -60℃	



Hubei CONO Technology Co., Ltd
Tel/ Fax:0086-27-87137247
Email: Support@cono-tech.com
www.cono-tech.com